

EzyVent™

Rangehood Ventilation System

Two rangehood venting boobytraps – and how the **EzyVent™** Ventilation System solves them quickly, safely and inexpensively.

The hidden boobytraps

The first problem with rangehoods is that, to perform at their best, they need to be properly vented to the outside of your home. So you need reliable venting to suit your particular rangehood model.

The second problem is that, for them to be properly vented, you need all the necessary components *on site at the time of installation*. Otherwise you can suddenly find yourself in the middle of extra costs, frustrating delays and messy, unsightly “solutions” like duct tape and sealant. Or hazardous ones, like combustible PVC pipe (plastics are no longer supposed to be used for this purpose).

Usually, the first you’ll know of it is when your plumber or kitchen installer asks “where’s the *venting kit* for the rangehood?”

The bad news is... it’s *your* job to provide it.

This can mean hours of traipsing around plumbing suppliers, appliance or hardware stores assembling a collection of odds and ends to *hopefully* do the job – or spending a *lot* more money on a custom-built venting system.

Even then, it will probably rely mostly on unsightly silicone sealer and plastic tape to prevent greasy, smelly fumes and smoke escaping back into your kitchen. Worse still, this kind of “creative solution” may even compromise the final appearance, safety and functionality of your kitchen.

It all adds extra time, expense and frustration to the installation of your new rangehood – or the installation of your entire kitchen, if it’s being renovated or replaced.

The complete solution

EzyVent™ is the low-cost, SAFE solution that’s as elegant as it is quick, simple and effective. **EzyVent™** is a complete, modular system made from sturdy galvanised sheet steel for a life-time of trouble-free service, guaranteed for 25 years.

Its modular range of versatile, interchangeable components means you need only purchase the exact items needed for any venting situation.

And because its four diameters fit most rangehood models, you can safely use any components from the **EzyVent™** system with your rangehood.

Why use Galvanised Sheet Steel instead of plastic pipe or concertina foil?

- Strong, lightweight and durable. Won’t rust!
- Easy to cut or shape with tin snips, hacksaw.
- Proven effective in the harsh Australian climate.
- Easy to paint, easy to clean.
- Can be used as a design feature, in natural colour or painted.
- No fire risk. No deadly fumes or carcinogens.
- Won’t sag, puncture, rattle or trap hazardous grease like flimsy, noisy, concertina-style ducting.
- Impervious to rats, mice, possums, European wasps and other pests, and no food build-up to attract them in the first place.
- Won’t rattle or vibrate due to air turbulence.
- Won’t collapse on bends or constrict air flow.
- Environmentally friendly and responsible.

EzyVent

ABN 59 435 766 115

3 Bridge Street
Eltham Victoria 3095
Freecall **1800 010 424**
Freefax **1800 010 464**
Mobile **0418 356 256**

E-mail
sales@ezyvent.com.au

Web Sites
www.ezyvent.com.au
www.rangehoods.info

EzyVent™ Ventilation System is the subject of numerous design registrations.

EzyVent™ is a trade mark of EzyVent.

©2008 **EzyVent**.
All rights reserved.
No reproduction by any means without prior written consent of **EzyVent**.

Issued 1 July 2008

EzyVent™ Ventilation Duct

- Cylindrical shape offers seven major advantages over square or oblong shapes:

1. Much stronger geometric shape – remains rigid under load.
2. Easier for penetrating roofing materials and for weatherproofing.
3. More versatile in difficult venting situations – easy to angle and offset using **EzyVent™** Elbows.
4. Cylindrical shape occupies

less cabinet space, providing increased storage space above rangehood.

5. Can be easily painted or left in natural state as a design feature.
 6. Easy to remove for cleaning, or for cabinet or rangehood maintenance.
 7. Crimped end allows neat, fast attachment to extensions or fittings.
- Proper diameters allow optimum airflow, enhances rangehood

performance and reduces wear and tear on fan.

- Galvanised 0.6 mm sheet steel – strong, yet light and easy to handle.
- Easy to cut to size with tin snips or hacksaw.
- Fits the other **EzyVent™** system components perfectly.
- Four diameters fit most rangehood outlet sizes for optimum flexibility.

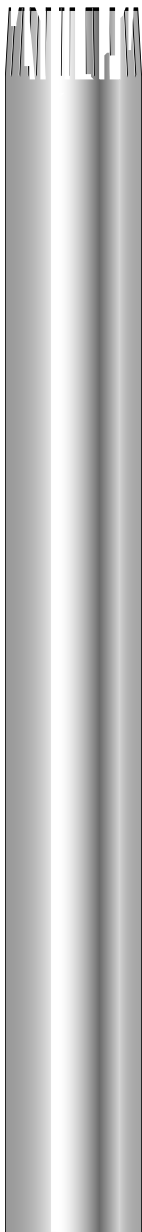

EV100-VP

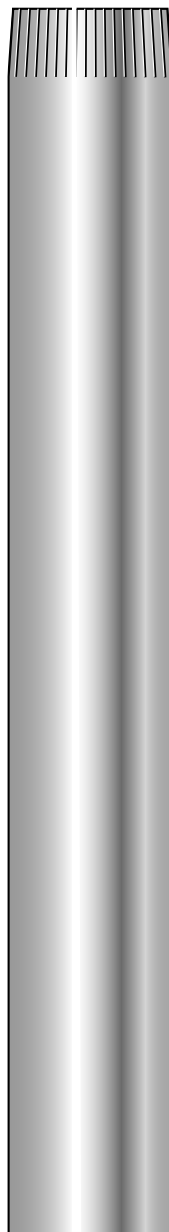

EV120-VP

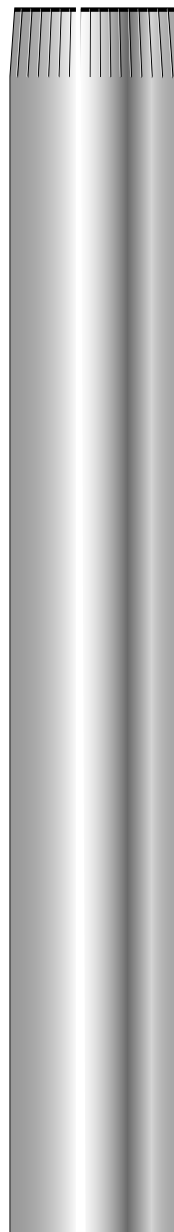

EV125-VP

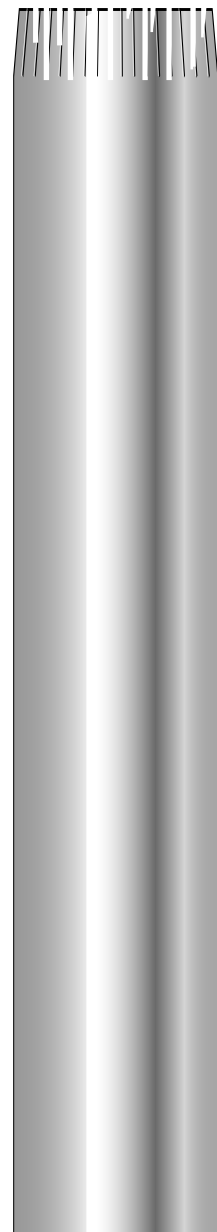

EV150-VP

EzyVent™ Roof Cowl

- Designed to fit onto the appropriate **EzyVent™** Ventilation Duct.
- Intelligent design allows unrestricted airflow, yet remains fully shielded against the weather.
- Manufactured from sturdy galvanised sheet steel – maintenance-free.
- Easy to paint to match existing exterior materials.

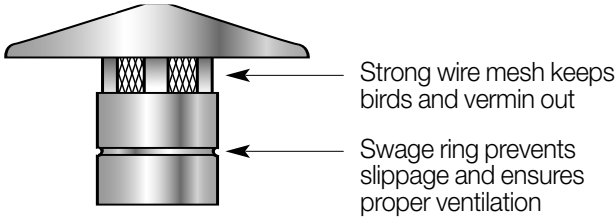

EV100-RC

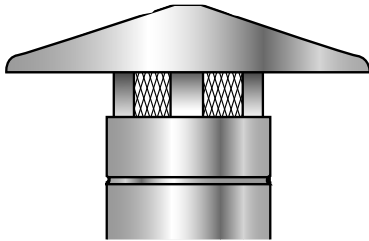

EV120-RC

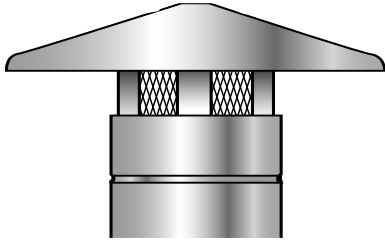

EV125-RC

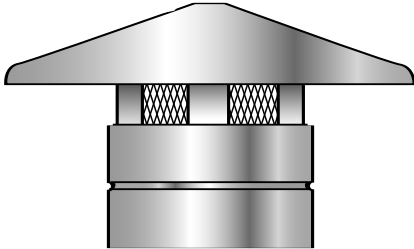

EV150-RC

EzyVent™ Wall Vents

- Two louvre types – fixed or gravity – in four diameters to suit all venting situations.
- Allow venting through any wall thickness when used with **EzyVent™** Venting Duct.
- Easily attached to any wall type – such as brick, timber or aluminium.
- Allow unrestricted airflow to the atmosphere.
- Both types allow air to escape easily, while preventing insects and vermin from entering the vent. (Fixed louvre models lined with fly wire.)
- Easily removable to clean or paint.
- Provide complete weather proofing of wall penetration.
- Attach easily to standard **EzyVent™** Venting Duct without any need for tape or silicone sealant.
- Attach to **EzyVent™** Venting Duct or Elbows for rear or side wall venting.
- Manufactured from weather-resistant white plastic – no maintenance.
- Easy to paint to match existing exterior materials, or leave unpainted.

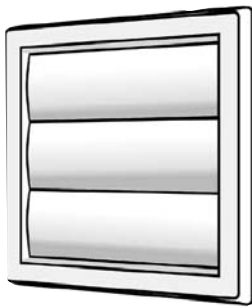

EV125-WG – Gravity Louvre

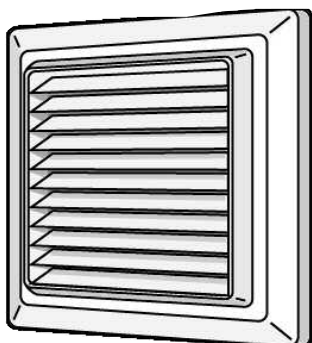

EV150-WF – Fixed Louvre

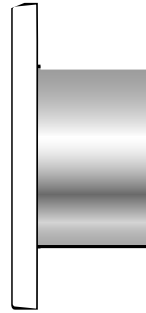

EV100-WG

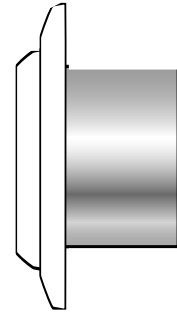

EV100-WF

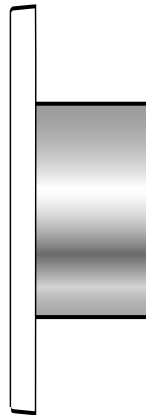

EV120-WG

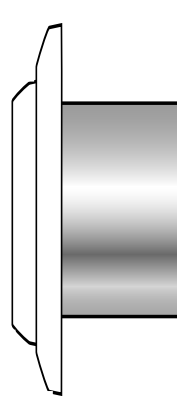

EV120-WF

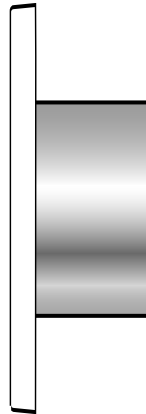

EV125-WG

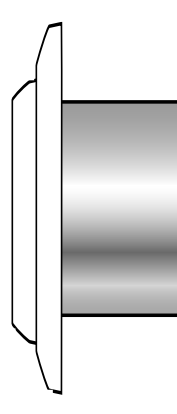

EV125-WF

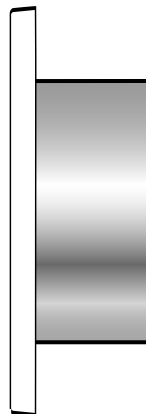

EV150-WG

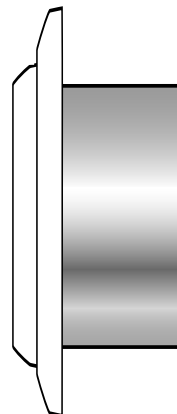

EV150-WF

EzyVent™ 90° and 45° Elbows

- Attaches to standard **EzyVent™** Venting Ducts.
- Allows increased flexibility in many venting situations.
- Elbows can be fitted together to provide an offset in difficult areas, such as bypassing roof beams.
- “Lobster back” design allows smoother airflow with no concertina effect to restrict airflow, create vibration or trap grease (potential fire hazard, may attract vermin).
- “Lobster back” design can be left exposed as a design feature.
- Crimped end allows easy connection to all **EzyVent™** components.
- Tight radius means less overall height required for elbows – easier to fit into cabinets and ceiling space.
- Manufactured from sturdy galvanised sheet steel. No maintenance required.
- Easy to paint if required to match existing colour scheme.

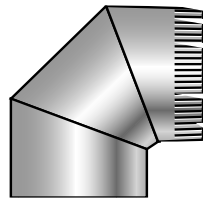

EV100-EB90

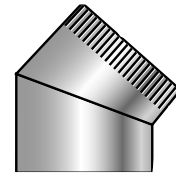

EV100-EB45

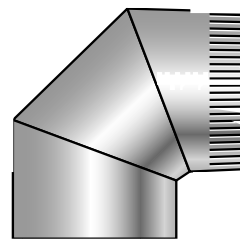

EV120-EB90

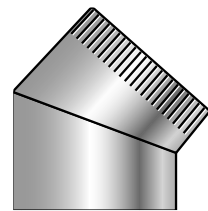

EV120-EB45

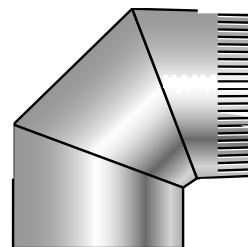

EV125-EB90

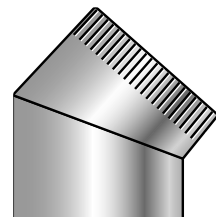

EV125-EB45

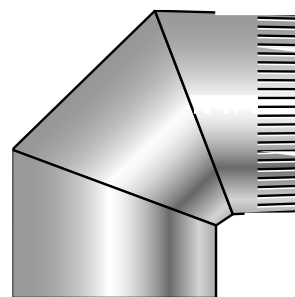

EV150-EB90

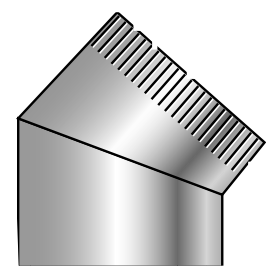

EV150-EB45

Examples of possible combinations

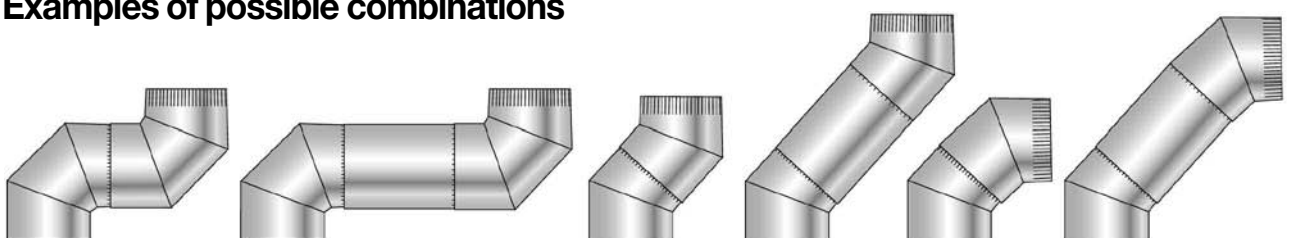

Combinations of Elbows and lengths of **EzyVent™** Ventilation Pipe can be used to bypass obstructions.

EzyFlash Flashing Units

Roofite for Steel Roofs

- Ideal solution for flashing **EzyVent™** Venting Duct on all steel roofing.
- Easy to drill and bolt into position.
- Improved performance.
- Accommodates all **EzyVent™** Venting Duct diameters.
- Patented design features deliver multiple benefits to both the installer and the client.
- Made from weather-resistant, flexible EPDM and Silicone for longer life and easier installation.
- Malleable, bonded aluminium base plate moulds easily to roof surfaces.
- Easily-identified sizing rings and internal moulded o-rings offer quick and easy fitting to **EzyVent™** duct pipe, improved sealing and providing greater strength.
- Aesthetically pleasing and technically superior finish to external venting.
- Save time, trouble and money for a thoroughly professional result.

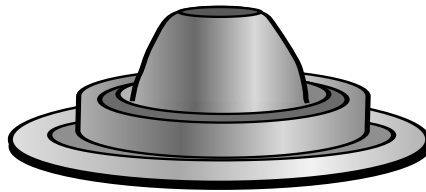

EV-RT Steel Roof – Natural Grey

Tiletite for Tiled Roofs

- Accommodates all **EzyVent™** Venting Duct diameters.
- Bonded aluminium mesh in base plate makes it easier to handle and mould than old-fashioned, troublesome lead. No health hazards, either.
- Patented adhesive bonds flashing firmly to tile surfaces.
- Easily-identified sizing rings and internal moulded o-rings offer quick and easy fitting to **EzyVent™** duct pipe, improved sealing and greater strength.
- Available in Grey or Terra Cotta for aesthetically pleasing and technically superior finish to external venting.
- Save time, trouble and money for a thoroughly professional result.

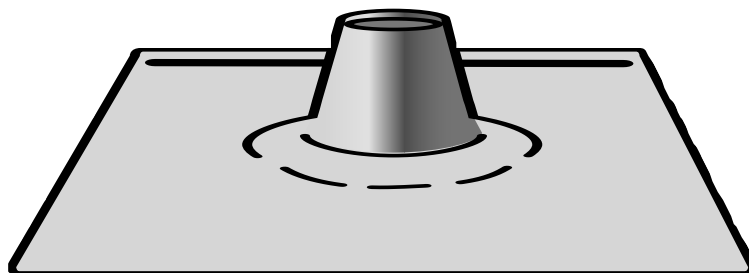

EV-TTG Tiled Roof – Grey
EV-TTR Tiled Roof – Terracotta

Here's how easy it is to select your own **EzyVent™ Ventilation System**

EzyVent™ is the quick, clean, safe, elegant solution to your rangehood ventilation needs. Just choose the configuration to suit your situation.

The key is to select the right diameter to ensure that your **EzyVent™** system connects properly to your rangehood, with

either top or rear outlet.

The six components are available in four sizes to fit most rangehood outlet/ coupling ring diameters.

The two **EzyFlash** flashing units are adaptable to all diameters in the **EzyVent™** range.

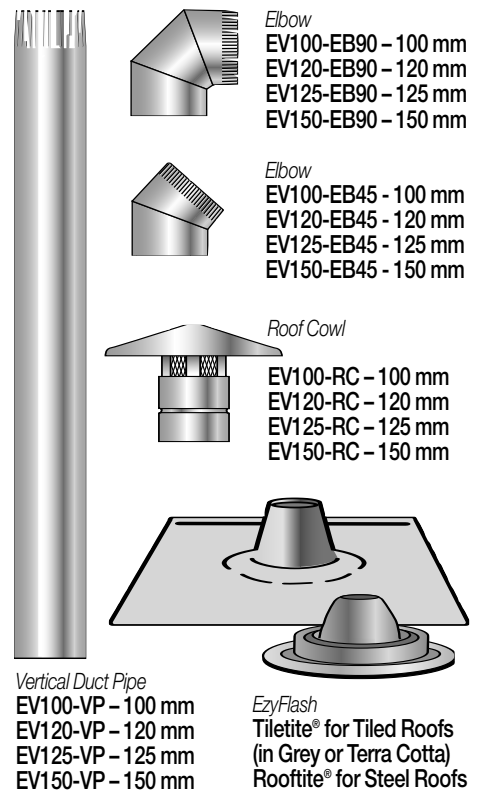

Venting to Roof or Ceiling

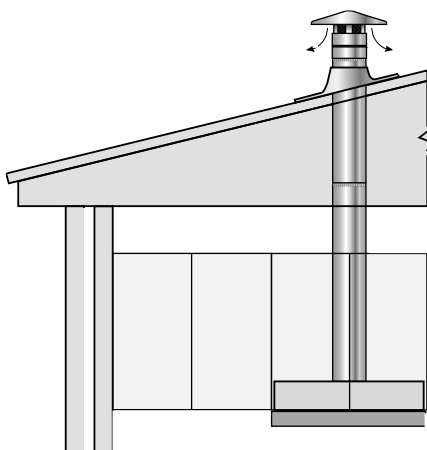

Venting into ceiling space causes build-up of grease and other flammable materials that attract rats, mice, possums, wasps and create a serious fire hazard

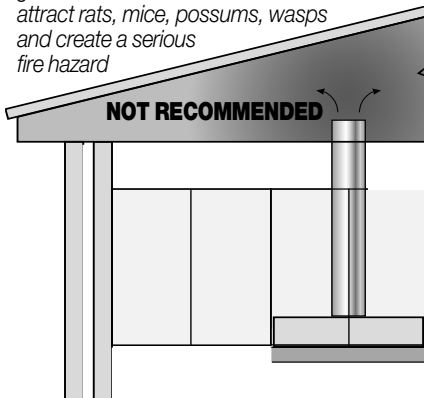

Outlet to roof

- EV120-VP Venting Duct Pipe(s)
- EV120-RC Roof Cowl
- **EzyFlash** Flashing

Outlet to ceiling

- EV120-VP Venting Duct Pipe (900mm unit will reach from rangehood into most ceilings)

Note: Venting to outside is preferable.



Wall Vent - Gravity Louvre
EV100-WG - 100 mm
EV120-WG - 120 mm
EV125-WG - 125 mm
EV150-WG - 150 mm



Wall Vent - Fixed Louvre
EV100-WF - 100 mm
EV120-WF - 120 mm
EV125-WF - 125 mm
EV150-WF - 150 mm

Venting to Rear Wall or Side Wall

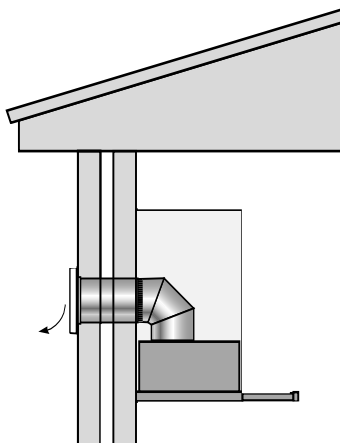

Outlet to rear wall

- EV120-EB90 Elbow
- EV120-VP Venting Duct Pipe
- EV120-WG Wall Vent

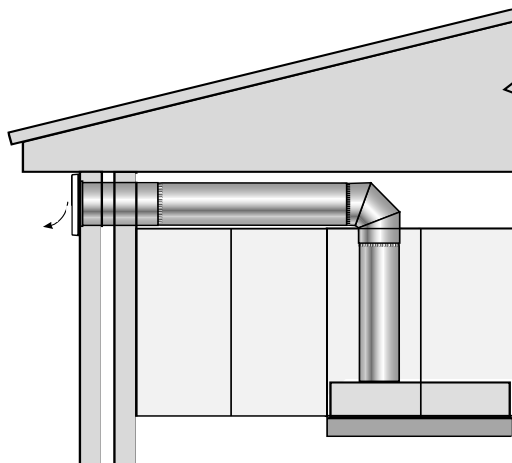

Outlet to side wall

- EV120-EB90 Elbow
- EV120-VP Venting Duct Pipe
- EV120-WG Wall Vent

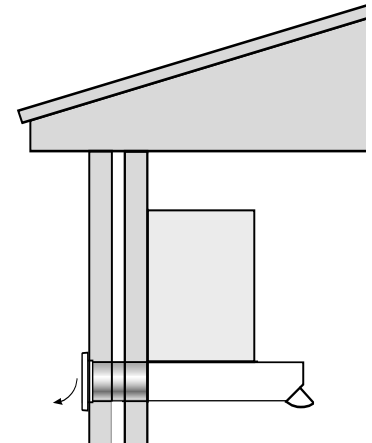

Round rear outlet to rear wall

- EV120-VP Venting Duct Pipe
- EV120-WG Wall Vent